

LCD DIGITAL METER No, 1/5

CODE	752-1430800
APPLICATION	PCX125 (JF28) /150 (KF12)

- Read and understand the instruction before installing.
- Please keep the instruction for later needs.
- ※The instruction is not included in repair parts, please keep this instruction and use it as setting manual.

■ ATTENTIONS (MUST READ)

- Do not make a strong impact with LCD DIGITAL METER, as it is precision mechanical equipment. Do not modify the way which is not listed or it will cause damage and trouble.
- LCD DIGITAL METER is designed and made exclusive for PCX125/150, do not use on other models.
- We are not responsible for damages and accidents caused by assembling mistake and improper setting.
- Please ask mechanic for assembling and setting.
- Ask a specialist at specialty shop if you do not understand the role of the surrounding parts.
- This instruction sheet is for the instruction with stock condition.
- Refer to the manufacturer HONDA service manual when installation
- Please contact a mechanic nearby immediately when you find something unusual.
- LCD DIGITAL METER is designed for the race in the circuits.
- Users should agree and assume full responsibility and all liability with respect to compliance with laws and regulations when using LCD DIGITAL METER for street use.
- Bolts and nuts may get loosen by engine vibration.
- Please check and make sure each part of bolts and nuts are not loose before running.

IMPORTANT!! (MUST READ)

Operating standards for TACHOMETER

- Do not place a meter or wiring near the parts which generates a large noise like ignition coil, plug cap, high tension cord and so on.
- It activates normally for the PCX with stock electrical condition. It might not work normally with modified PCX (ex non resistor spark plug / HID headlight / audio products. etc)

▼How to take care of meter

- LCD DIGITAL METER is not completely water-proof. Try not to get wet as much as possible.
- Keep motorcycle at the place where it does not get rainy. Glass might get fogged with high humidity weather
- Keep motorcycle at the place without much vibration, to avoid breakage.
- Meter might not activate correctly when mounted close to the motor due to heat.
- ※Any failure due to heat or vibration is out of warranty.
- Disassembling the meter is not allowed, to avoid malfunction and breakage.

SPECIFICATIONS

MENU	RANGE	REFERENCE
SPEED	0 ~ 160km/h (0 ~ 99mph)	
REVOLUTION	0 ~ 16000rpm	
TOTAL / TRIP	TOTAL : 99999km (62136mi) TRIP : 9999.9 (6213mi)	trip erasable
TIME	24 hour notation	
TEMP. (AIR)	* °C	water temp gauge required for water temperature
VOLTAGE	9 ~ 15V DC	battery voltage
FUEL LEVEL	5 bar graph	graph notation

PACKING LIST

NAME	CODE	QTY
LCD DIGITAL METER COMP	-	× 1
20P CONVERT HARNESS	-	× 1
TEMPERATURE SENSOR	-	× 1
2P EXTEND HARNESS	-	× 1

OPTION PART (SOLD SEPARATELY)

DIGITAL WATER TEMP GAUGE JOINT	752-0560014	× 1
--------------------------------	-------------	-----

CAUTIONS

◆INSTALLING & REMOVING OUTSIDE PLASTICS

- ※Removing outside plastics is required when installing KITACO LCD DIGITAL METER.
- Removing outside plastics around spark plug is required when wiring tachometer.
- Make sure to refer to HONDA SERVICE MANUAL for installation.

●INSTALLING LCD DIGITAL METER

- Remove meter lens, gasket, meter comp and lower case off of stock meter.
- Install LCD DIGITAL METER in the reverse way. (Meter gasket required to exchange when found wear.)
- ※Make sure to switch the selector behind the meter.
- Refer to below illustration for TACHOMETER wiring.
- ※Connect pick up coil (black for signal reception) to ignition coil. Wire should be align to inside the leg shield cover. (Refer to page 2)

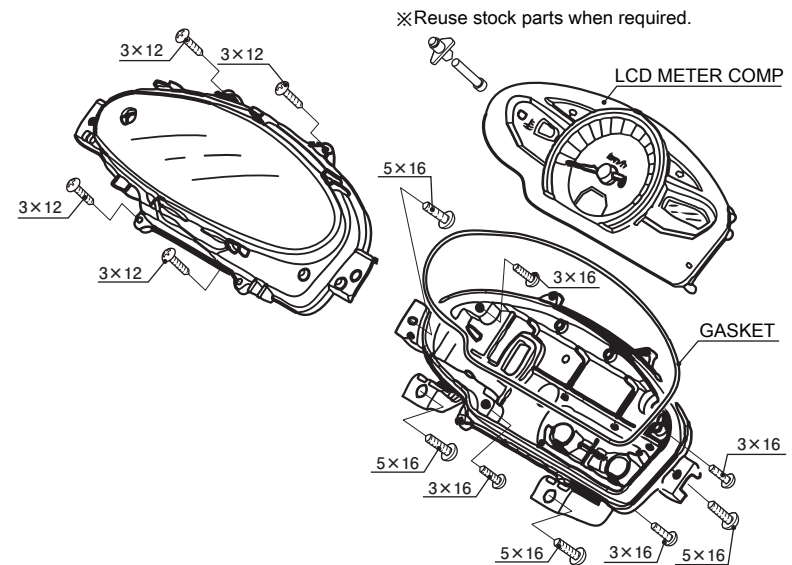

●Wiring Diagram

- ※Make sure to connect correctly. Must refer to Honda service manual.
- ※Make waterproof treatment on wires and couplers after connection

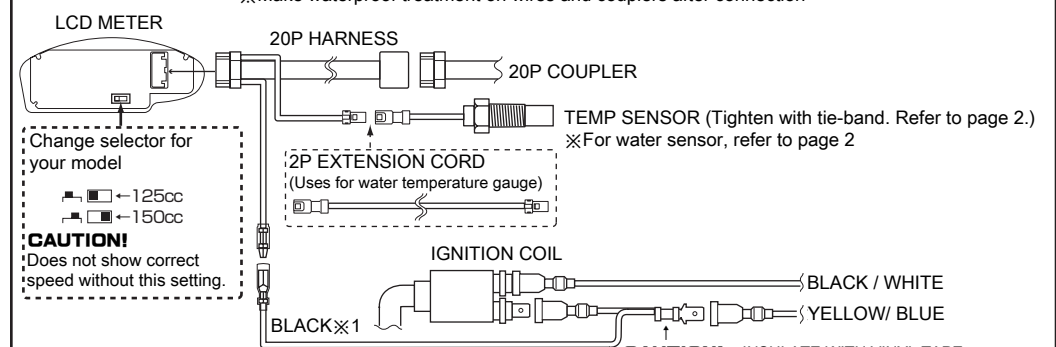

○PICK UP WIRE (SIGNAL RECEPTION / BLACK LEAD WIRE)

- ※1. Black lead wire is co-axial wire. (CAUTION! DO NOT PEEL OUTSIDE TUBE)
- If indicator does not activate correctly due to noise, please align outside tube (black wire) with motorcycle frame for making body earth.

CAUTION! INSULATE WITH VINYL TAPE

LCD DIGITAL METER No. 2/5

CODE 752-1430800

HARNESS (SENSOR) DIAGRAM

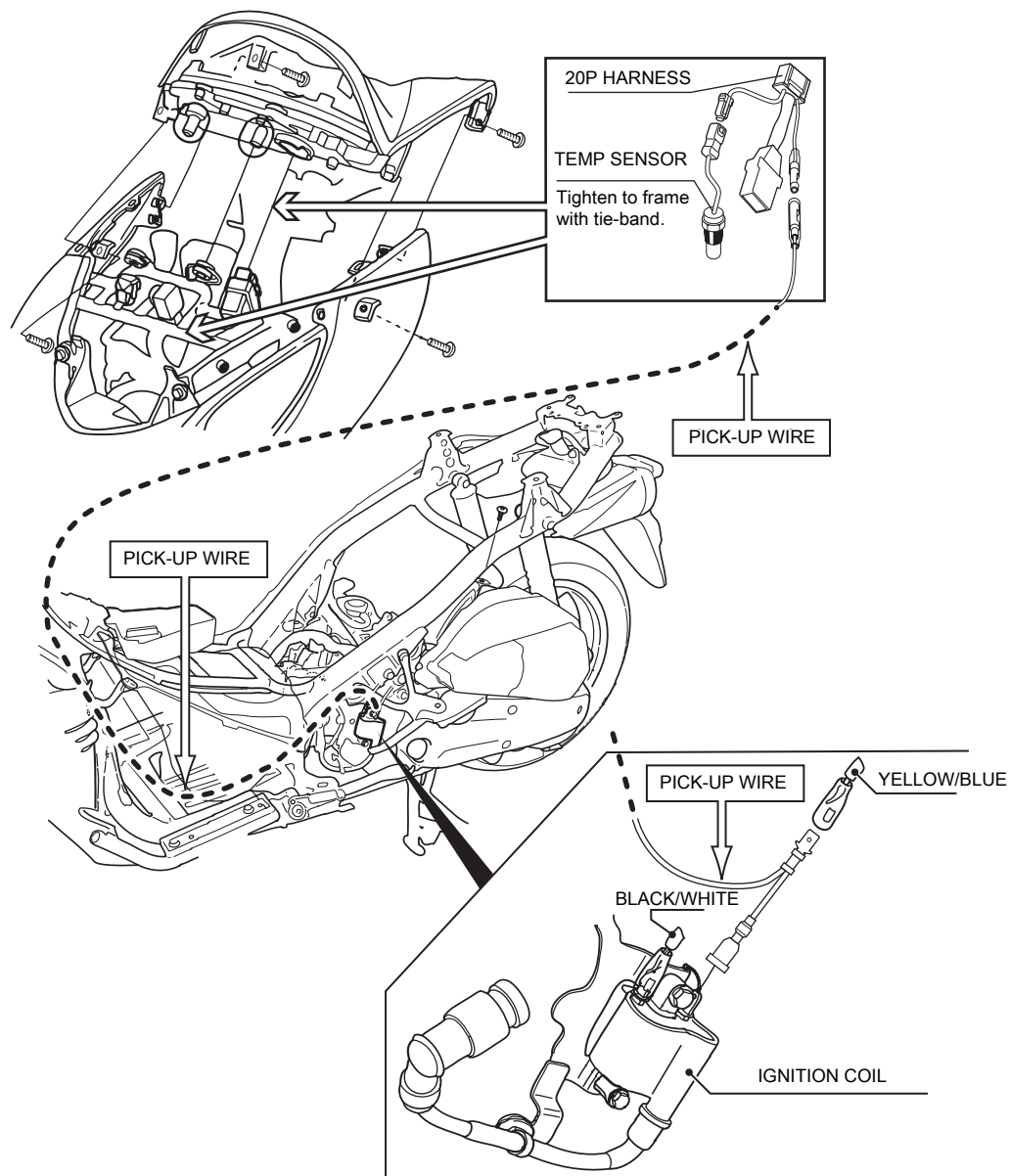

USING AS WATER TEMPERATURE GAUGE

T-shape attachment (option) is required.

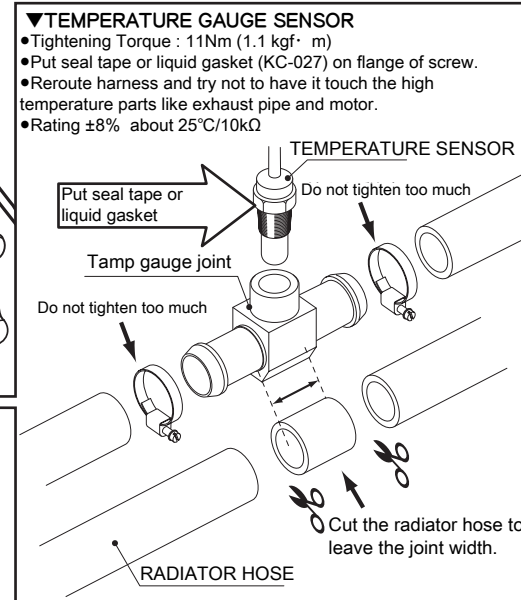
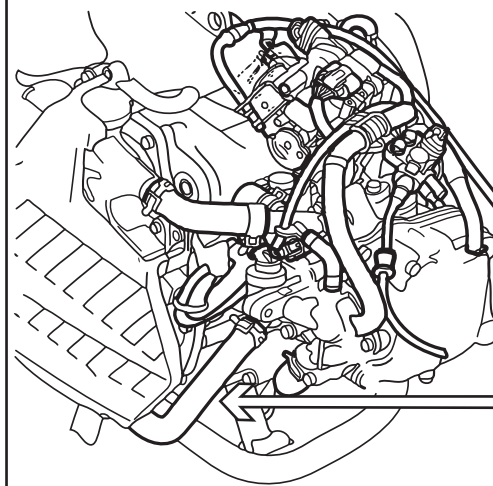

INSTALLING PROCEDURE

- Take off water drain bolt off and drain all the radiator coolant.
 - Cut the radiator hose in the middle (straight part), put temp gauge joint between them.
 - Tighten the hose band tightly not to have radiator coolant leak when running.
 - Please release air when putting in radiator coolant. (Refer to Honda service manual)
- ※ New radiator hose is required when taking off the gauge joint.

LCD DIGITAL METER No. 3/5

CODE 752-1430800

NAMES & FUNCTIONS

No.	NAME	FUNCTION
1	SETUP KEY	Setting for each function. Select / Switch (Press : 0.8±0.3 sec.), Enter (Press and hold more than 2 sec.)
2	TOTAL DISTANCE [TOTAL]	Km / Mile selectable
3	PIT-IN INDICATOR	Oil exchange / Drive belt exchange alert
4	OIL EXCHANGE INDICATOR	Every 5,000 km (every 1,000 km for total 3km or less)
5	DRIVE BELT EXCHANGE	Every 20,000 km (every 1,000 km for total 3km or less)
6	RUNNING DISTANCE [TRIP]	Able to reset
7	ANALOG SCALE SPEED & DIGITAL TACHO	Display selectable
8	ANALOG SCALE TACHO & DIGITAL SPEED	Km/h · Mph selectable
9	TIME	24 hour notation (setting required)
10	BACK LIGHT (LCD PANEL)	Color (RED / WHITE / BLUE), 3 step intensity
11	PGM-FI ERROR CODE (E1 ~ E12)	Self-diagnosis function (Refer to no.5 / Honda service manual)
12	TEMPERATURE	Outside temperature (For water temp, water temp gauge joint required)
13	FUEL GAUGE	-
14	VOLTMETER	Battery Voltage
15	STAND BY INDICATOR	Idling Stop System Display

※Illustration below shows all functions at the same time (Usually, it does not show everything)

※Indicators which are not on the illustration are the same as stock meter.

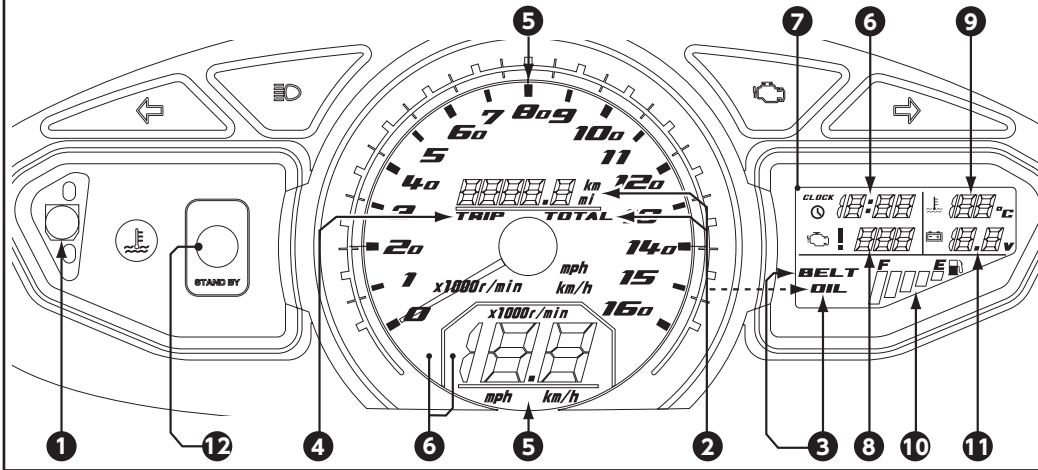

FUNCTION DISPLAY MODE (Refer to the right page)

CAUTION! : Setting during driving motorcycle is not allowed, for safety reason. It may cause serious accidents.

Move to next function setting by pressing SETUP KEY ①. Press and hold for "enter".

TOTAL DISTANCE : Pit-in sign display setting (oil / drive belt change-out rate setting ③)

TRIP DISTANCE : Reset function (Refer to no.4)

SPEEDOMETER & TACHOMETER DISPLAY CHANGE : Analog / Digital display change (Refer to no.4)

CLOCK : Time setting (Refer to no.5)

BACKLIGHT : Colors (Red / white / blue : intensity 3-step)(Refer to no.5)

SETTING FINISHED

No.	NAME	FUNCTIONS
1	SETUP KEY	Select / Switch (Press : 0.8±0.3 sec.) Enter (Press and hold more than 2 sec)

FUNCTION DISPLAY MODE

※Change function mode with ignition key on (with display panel on)

LCD panel displays as follows,

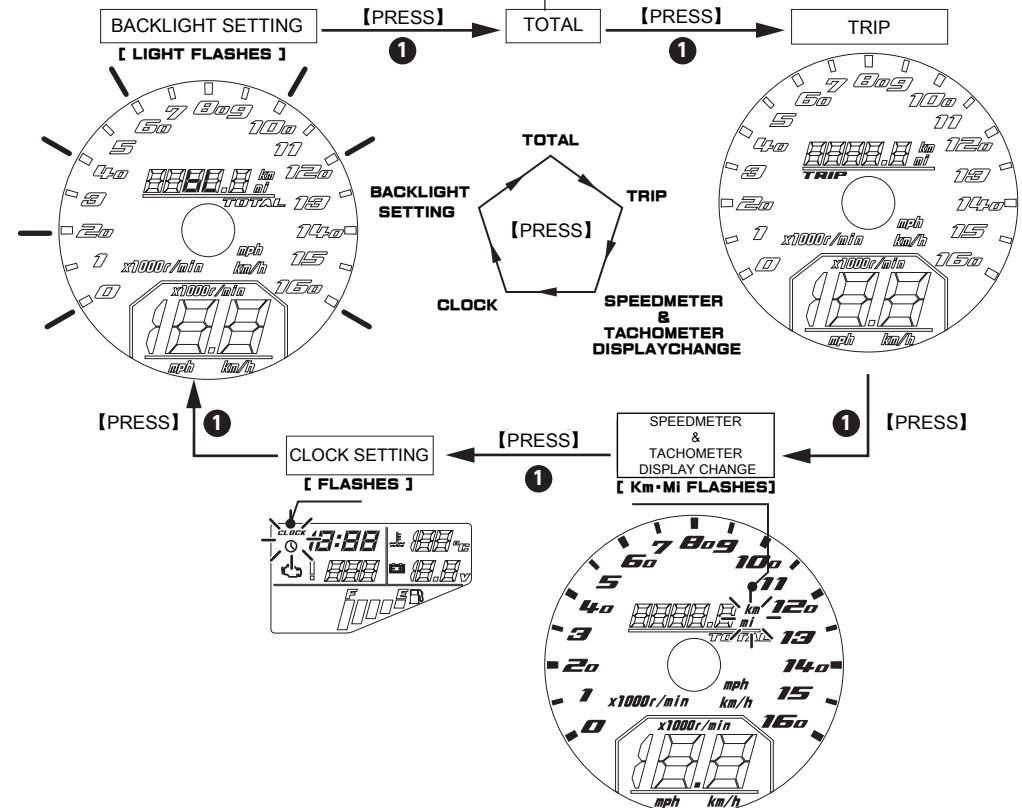
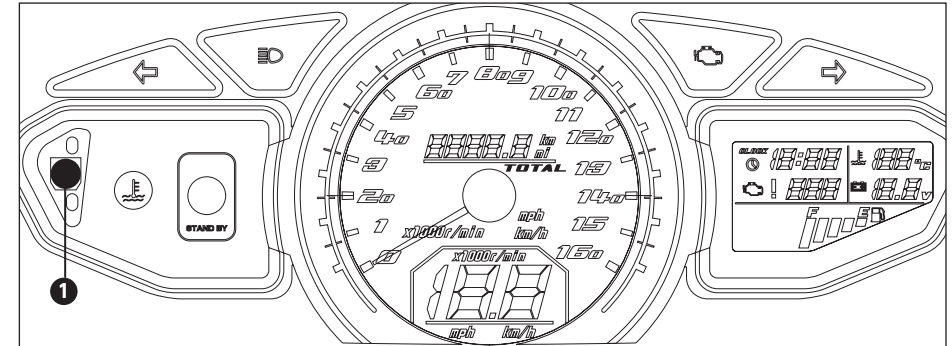

LCD DIGITAL METER No, 4/5

CODE 752-1430800

SETTING

▲If it takes 10 sec or more without touching anything, it turns back to TOTAL mode.

No.	NAME	FUNCTIONS
1	SETUP KEY	Select / Switch (Press : 0.8±0.3 sec.) Enter (Press and hold more than 2

OIL CHANGE-OUT RATE (PIT INDICATOR) SETTING MODE

Setting of engine oil exchange time for replacement.

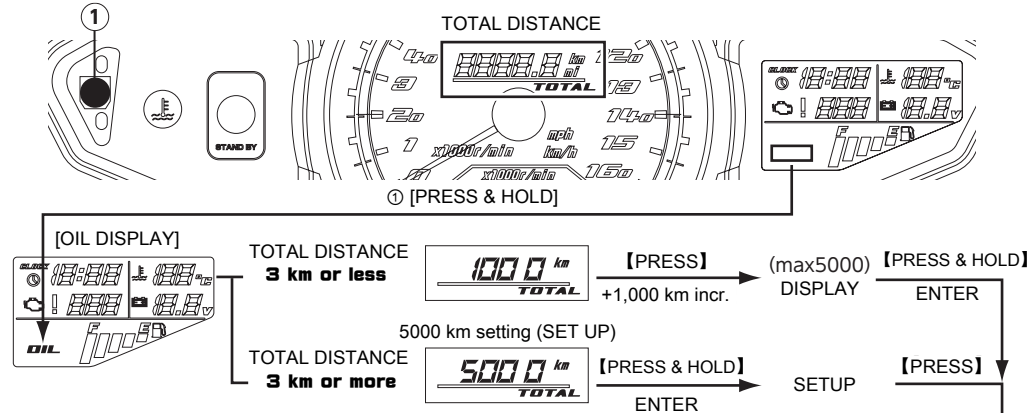

DRIVE BELT CHANGE-OUT (PIT INDICATOR) SETTING MODE

Setting of drive belt exchange time for replacement.

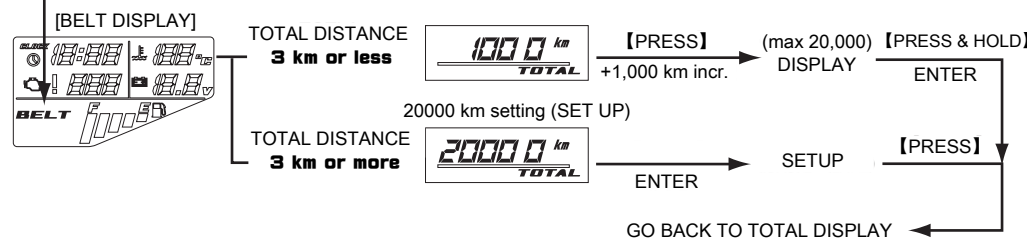

TRIP METER SETTING MODE

Setting the distance traveled to "0 km"

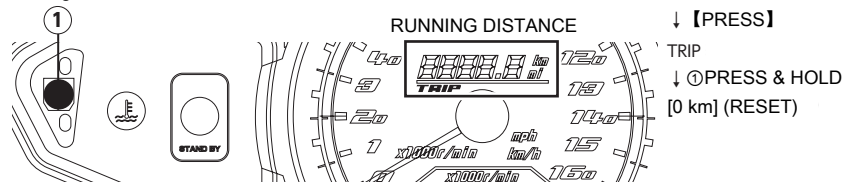

TO SPEED & TACHOMETER DISPLAY SETTING ▶

SPEED & TACHOMETER DISPLAY SETTING MODE

Setting the ANALOG SCALE & DIGITAL DISPLAY ▼

【PRESS】

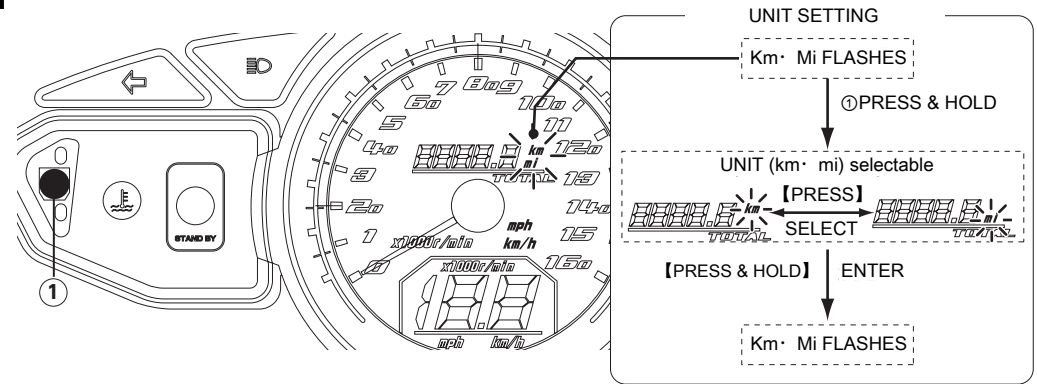

ANALOG / DIGITAL DISPLAY SETTING

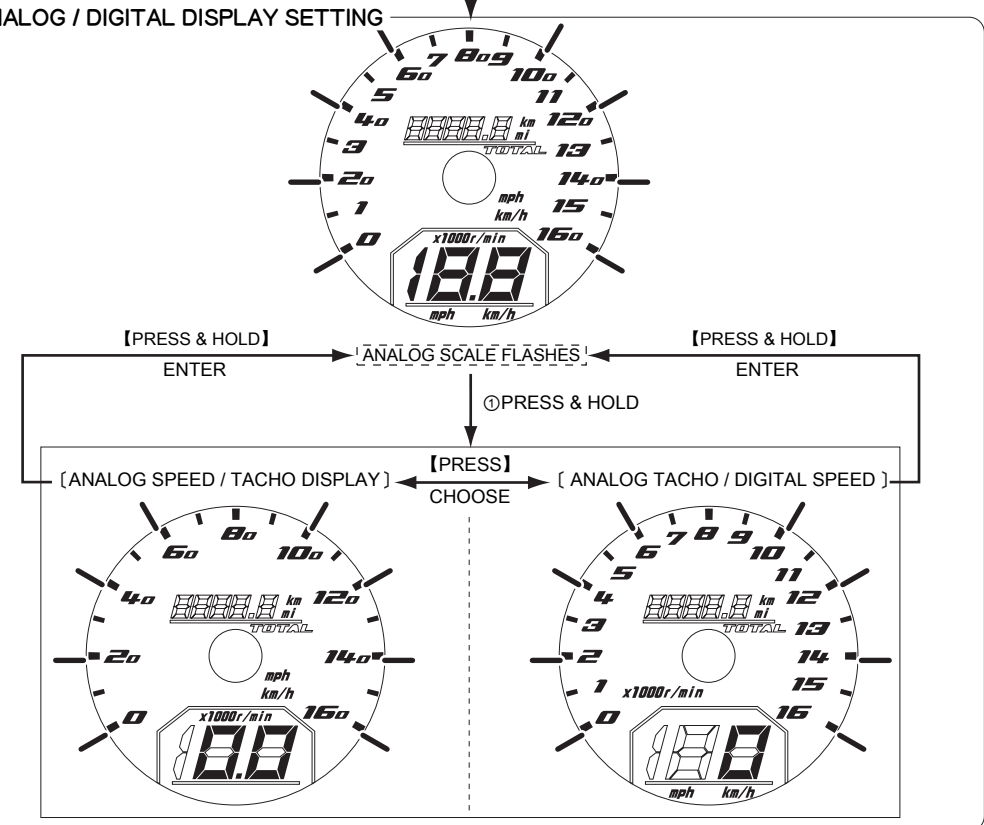

TO CLOCK SETTING MODE

▼ 【PRESS】

LCD DIGITAL METER No. 5/5

CODE 752-1430800

SETTING

If it takes 10 sec or more without touching anything, it turns back to TOTAL mode.

No.	NAME	FUNCTIONS
1	SETUP KEY	Select / Switch (Press : 0.8±0.3 sec.) Enter (Press and hold more than 2

CLOCK SETTING MODE

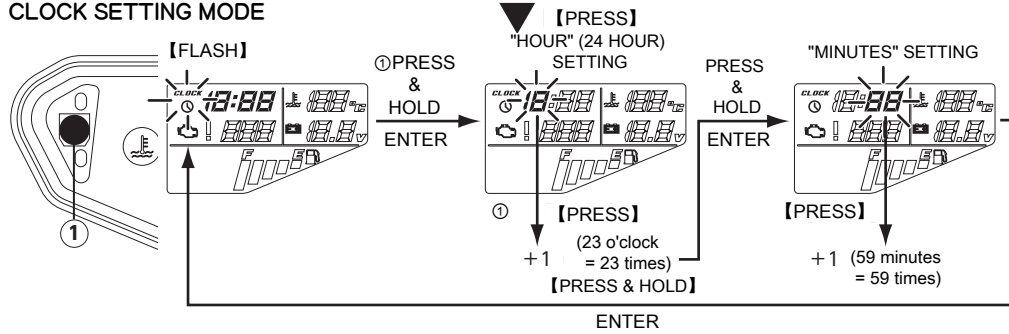

BACKLIGHT (b1) SETTING MODE

Setting of LCD PANEL LIGHT
(COLOR : RED / GREEN / BLUE · INTENSITY : 3 STEP)

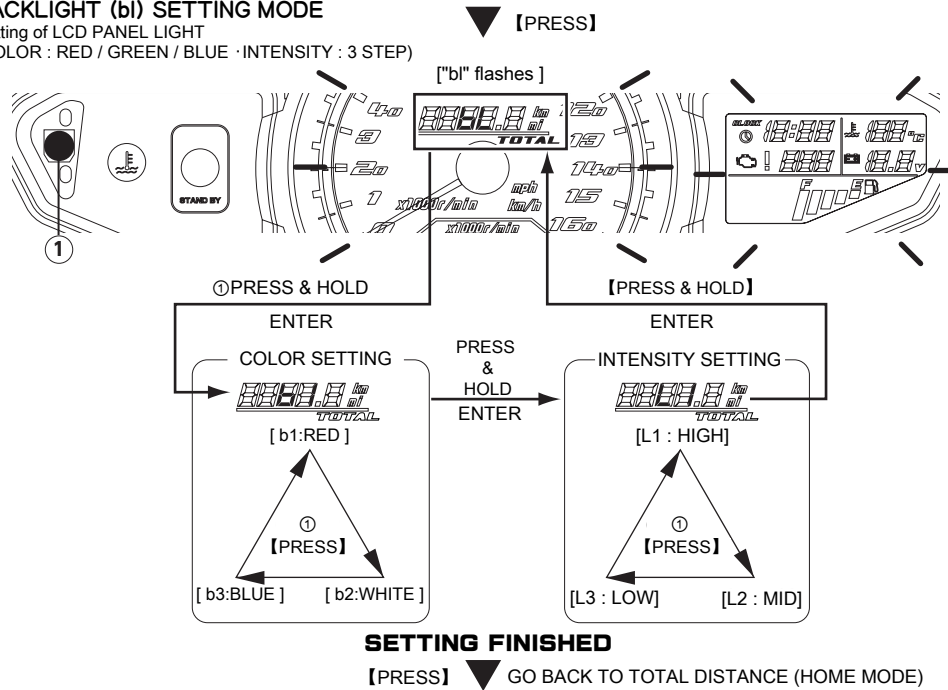

FAULT DIAGNOSIS FOR SELF-DIAGNOSIS FUNCTION (REFER TO HONDA SERVICE MANUAL)

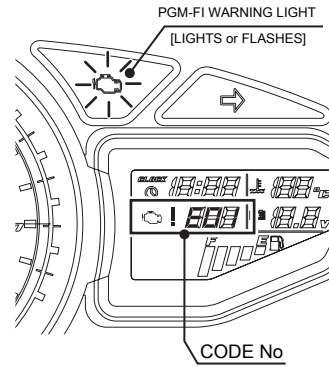

Refer to Honda service manual how to operate self-diagnosis function.
 •PGM-FI warning light is on or flashes the same as genuine meter, depending on the fault condition.
 (If PGM-FI is not faulty, it is not on or does not flash.)
 •Code number will be displayed on LCD panel, when warning light is on or flashes.
 Please refer to Honda service manual for the details like flash numbers and so on.
 (Code number is Kitaco original, not on service manual)

PGM-FI warning light	OFF	OFF	ON	1 FLASH	7 FLASHES	8 FLASHES	9 FLASHES	11 FLASHES	12 FLASHES	21 FLASHES	29 FLASHES	52 FLASHES
CODE No	E01	E02	E03	E04	E05	E06	E07	E08	E09	E010	E011	E012

Refer to HONDA SERVICE MANUAL for fault diagnosis & the fail-safe contents

131009

KITACO JAPAN

3-8-13 NAGATA
HIGASHI-OSAKA,
OSAKA, 577-0015.